

**SOMMER**  
Made in Germany

garage door operators





sectional door

swing door

canopy door

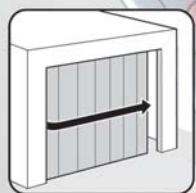

horizontal sectional door



wing door

## Application area

SOMMER garage door operators are suited for the following types of doors:

- sectional doors
- swing doors
- canopy doors (with special accessory)
- horizontal sectional doors (with special accessory)
- wing doors (with special accessory)

For every type of door there are many special accessories if necessary. SOMMER garage door operators are **applicable to doors of all well-known manufacturers** in new buildings as well as re-fitting.

## TÜV, RAL

SOMMER itself is certified under ISO 9001. The entire company is continuously monitored and inspected by independent test institutes.

SOMMER garage door operators are tested by TÜV/GS, are monitored in the RAL Quality Assurance Association and achieved in many cases the highest test category.

A calmative feeling!



## Guarantee

Quality provides confidence.

We issue a **5-year guarantee** on our garage door operators – much longer than legally required. SOMMER stands for quality without compromises.





## Radio control system

### Secure transmission

The very secure SOMMER radio control system transmits the modulated frequency on 868.8 MHz. Other radio applications, such as baby phones, wireless speakers, wireless gongs etc. cannot use this frequency. Thus range problems and interferences are practically excluded.

### Burglar-proof

The 66-bit process of the SOMMER radio control system enables over 73 trillion different codes, and the Somloq Rolling Code system is effective against code tapping. Troublemakers and burglars have no chance anymore.

### A radio system for everything

With your SOMMER transmitter for the gate operator you can also control many other devices in or around the house.



## Safety

SOMMER garage door operators switch off safely and quickly when encountering an obstacle. Thus your darlings are always well protected.

SOMMER garage door operators are constantly tested with doors from nearly all manufacturers by independent test institutes, and the security is documented in accordance with legal guidelines and standards. We have already more than 400 test certificates!

## Technology

The system with the travelling motor is unique and patented worldwide. There is no moving endless chain or toothed belt and thus there are no wear parts like deflection pulleys. Additionally the gear is released. This also increases the durability of the operator.

The motor is self-locking and prevents your garage door from being pushed open violently. An additional mechanical lock in the rail is not necessary!

During a power failure the simple emergency release ensures that you can open the door.

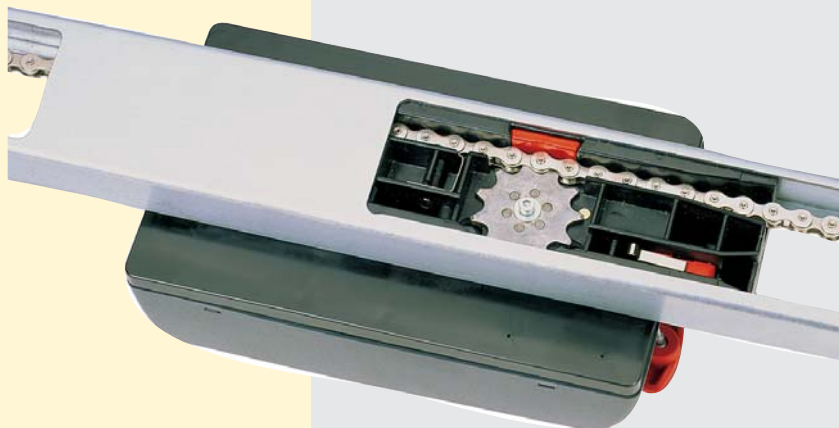



## SOMMER marathon

Our top-of-the-line product for private and commercial application offers you the highest level of operator technology.

High-performance motors with high-quality gears and power-saving transformers offer years of joy, convenience and safety without compromise.

The **powder-coated** rail perfectly tops this quality product off.



The SOMMER quick chain clamping enables a fast, safe and simple installation. Normal standard tools suffice.

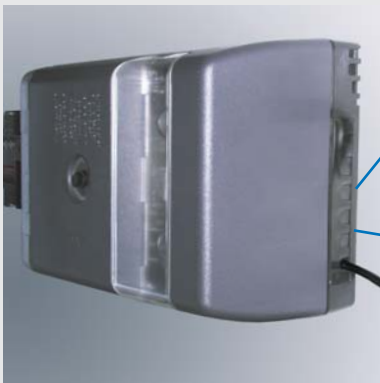

On the easy pluggable control unit there are connections for light barriers, external lighting, safety edges of various kinds and many other accessories.





## SOMMER duo

The bestseller. Compact, practical and powerful. Elaborated and extremely easy to install. Thanks to the separate control unit housing with power plug, any power socket in your garage can be used optimally. Minimum effort for top convenience.

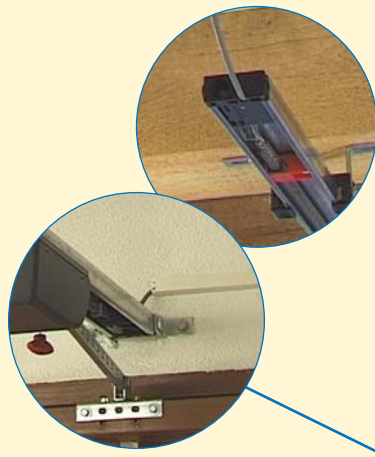

The illumination is always located at the right place in your garage - where you enter or leave the garage.

Installing a control button is not necessary, as this is already integrated in the control unit housing.

It is neither necessary to install a power socket on the ceiling. And thanks to the option of plugging the 24 V control cable where the track begins or ends, you always find the shortest way to the next power socket.

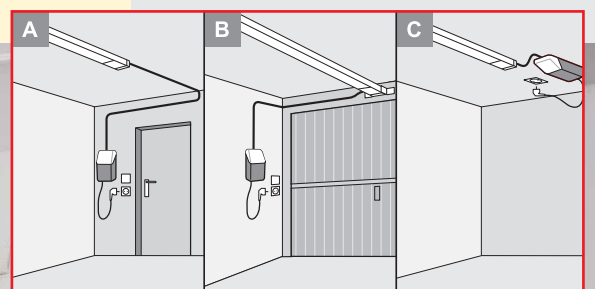



transmitter, 4-channel

item no. 4020V000

Chic and functional: the practical designer transmitter in a modern stainless steel version. The control buttons can be inserted completely. Unintentional usage is impossible. Four channels as standard version enable additional applications like e. g. illumination or several operators.



car and wall holder

item no. 4640V000

Car and wall holder for your designer transmitter. Supplied with special adhesive strips, which can be removed without a trace. For the car, inside next to the front door, next to the terrace door, in the cellar, etc. The transmitter can easily be inserted and removed.



Telecody

grey buttons item no. 4070V000

red buttons item no. 4070V002

**NEW from the 3rd quarter  
2005**

Just your personal code opens your door. The Telecody is simple to program and very burglar-proof. You do not need any key. This is convenient and it also means that there is no key that can be lost. A further advantage is the self-luminous buttons at night.



industrial transmitter

item no. 4010V000, 1-channel

item no. 4011V000, 5-channel

1-channel or 5-channel transmitter as a major type. Suitable for commercial use or if a larger design is desired.



key switch

item no. 5003-5010V000

For the activation of the operator by key. Different versions are available for flush or surface-mounting alternatively with or without profile cylinder.

Universal connection set for all sectional doors, very stable and adjustable with shortened curved pushed bar ("boomerang").

**universal sectional door fitting,  
adjustable  
item no. 3101**



Connection set for the automation of wing doors with SOMMER garage door operators. Suitable for doors with a maximum door width of 2800 mm. Other special dimensions are available on request.

**wing door fitting  
item no. 1501V000**



For using a door operator with an up-and-over door (non-projecting swing door). Attention: the length of travel can be shortened up to 700 mm.

**tilting arm  
item no. 1500V000**



Safe and fast emergency release, e.g. during a power failure, if there is no separate entry to the garage. Suitable for all sectional doors, side-opening sectional doors, lateral shutter doors and wing doors.

**release lock  
item no. 5036V000**



For the emergency release of the door per bowden wire - especially suitable for garages with a turning handle. Available in the lengths 0.55/2.30 m or 4.5/5.0 m (when using a tilting arm, an extended drive shaft or a wing door fitting).

**emergency release  
bowden wire  
item no. 1612V000**



# SOMMER

Made in Germany

www.sommer-torantriebe.de

further product range:



radio control system



swing gate operators



sliding gate operators



roller and awning drives



aluminium doors  
www.groke.de

## Overview of technical dates

| garage door operators   | duo 500 SL / 650 SL        | marathon 550 SL / 800 SL / 1100 SL |
|---|----------------------------|------------------------------------|
| length of travel<br>- standard<br>- extendable  | 2.600 mm<br>●              | 2.600 mm<br>●                      |
| max. traction and compressive force according to RAL-GZ 740                                 | 500 N / 650 N              | 550 N / 800 N / 1100 N             |
| max. speed  | 150 / 180 mm/s             | 180 / 130 / 130 mm/s               |
| nominal power, standby  | ~ 7 W / ~ 2 W              | ~ 2 W / ~ 2 W / ~ 2 W              |
| for gates with low-lintel-fitting   | ●                          | Ja m. s. Kopf                      |
| emergency release from inside, incl. SVS  | ●                          | ●                                  |
| motor protection via microprocessor,<br>incl. power and temperature monitoring              | ●                          | ●                                  |
| power-saving ring-core transformer  | - / ●                      | ● / ● / ●                          |
| power supply  | AC 220 - 240 V, 50 - 60 Hz | AC 220 - 240 V, 50 - 60 Hz         |
| plug-in motor control unit  | ●                          | ●                                  |
| fully automatic force reading /recognition of obstacles<br>incl. dynamic power system (DPS) | ●<br>●                     | ●<br>●                             |
| connection for warning light  | ●                          | ●                                  |
| 24 V output (regulated 0,1 A)   | ●                          | ●                                  |
| selective early warning option  | ●                          | ●                                  |
| selective backjump option   | ●                          | ●                                  |
| soft run option (without loss of force via ramp)  | ●                          | ●                                  |
| safety connection for opener contact  | ●                          | ●                                  |
| adjustable safety connection functionality  | ●                          | ●                                  |
| connection for slip-door facility in the motor bogie unit                                   | ●                          | ●                                  |
| connection for the TorMinal   | ●                          | ●                                  |
| counter for operation cycles  | ■                          | ■                                  |
| precise drive direction control (OPEN / CLOSE)  | ●                          | ●                                  |
| adjustable partial door opening   | ●                          | ●                                  |
| door status display   | ●                          | ■                                  |
| quantity of radio channels  | 2                          | 2                                  |
| quantity of control inputs  | 1 ▲ / 2 ▲                  | 2                                  |
| quantity of safety inputs   | 1                          | 2                                  |
| evaluation 8,2 kOhm integrated  | -                          | ●                                  |
| evaluation safety edge system   | -                          | ■                                  |
| automatic close mode, adjustable  | -                          | ●                                  |
| connection for red traffic light  | -                          | ●                                  |
| floating relay output with programmable function  | -                          | ■                                  |

<sup>1</sup> for swing doors and sectional-horizontal-doors please follow the values in the installation instructions  
 ■ only in connection with TorMinal ● yes ▲ without safety connection

your stockist